

# Amphenol

COMMUNICATIONS SOLUTIONS

## RotaConnect® Board-to-Board Product Presentation

 **FCi Basics**

Industry recognized portfolio combining leading edge technologies and proven solutions

Wire to Board Core	Wire to Board eMobility	Input Output FFC FPC	Backplane	Board to Board
<p>BergStik® Minitek® PV® Dubox® Quickie®</p>	<p>MicroSpace™ MicroSpaceXS™ FlexLock™ WireLock® MicroSpace™ High Voltage</p>	<p>Clincher® SFW-SFV USB HDMI Modular Jack Universal Contacts USB Cable Assembly</p>	<p>Metral® DIN41612 Millipacs® HPC</p>	<p>MezzoStak® BTFW MicroSpeed® Conan® BergStak®</p>

## Leading Product Portfolio For Strategic Markets

**Automotive**  
BMS, Lighting, OBC, ADAS

**Industrial**  
PLC/Controls, ESS, Metering

**IT/Datacom**  
Servers, Storage, AI, Embedded

**Consumer**  
Home Automation, Appliances

## Structured To Make Customers Succeed

**Value Add Solutions**  
Tailormade Cable Assemblies

**Custom Competence**  
Design Local; Build Regional

**Global Footprint**  
China; France; India; Mexico; Malaysia

**Technology & Innovation**  
Dedicated Basics Engineering Teams

- The RotaConnect® Board-To-Board solution is a rotatable Board-to- Board SMT connector that can be used to support perpendicular, coplanar and angled connections, in multiple mating and un- mating directions for all needs.
- The hermaphroditic “mates to itself” design the RotaConnect® BtB solution enables mating at any angle between +90° and -60°, the connectors can be placed anywhere on the PCB and a single part number which will comprise both male and female contacts.
- It has been designed for Surface Mount technology application with tape and reel packaging
- The RotaConnect® BtB solution includes 2 ,4 and 6 positions with hold-down and locating peg options with a latching feature (connector with locating pegs only have latching feature)
- Optional side brackets are provided to improve the retention force between connector and PCB.
- The high temperature grade housing material is reflow solder compatible.

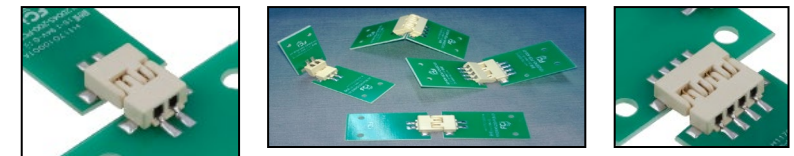

# Rotaconnect® - Solution Overview

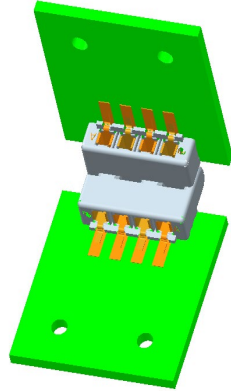

Rotate angle +90°

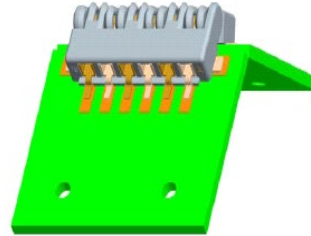

Rotate angle -60°  
(PCB T=1.57mm)

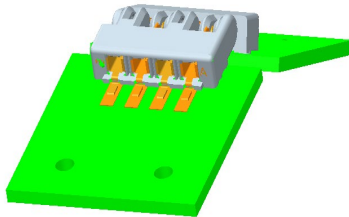

Rotate angle -60°  
(PCB T=1.57mm)

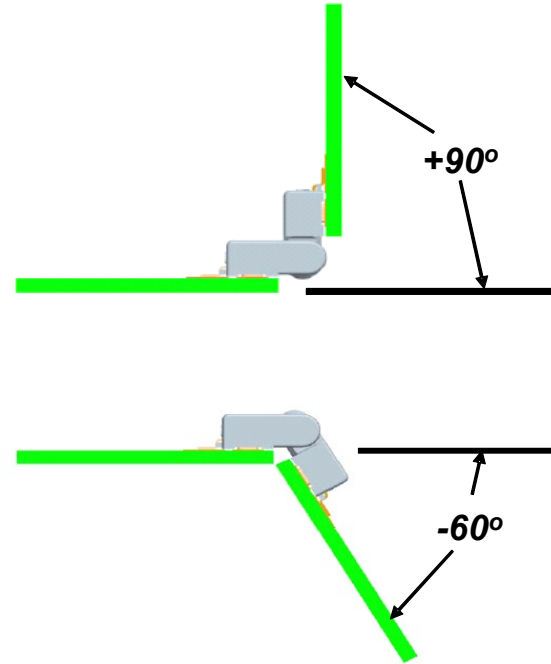



## Specifications

- Hermaphroditic: mates to itself (1 Part number)
- Contact System: dual beam spring contact
- Positions: 2,4 and 6 pos currently available
- Mating angle: all in between +90° and -60°
- RoHS compliance
- Product Spec. : GS-12-1079

## Materials

- Plating: GXT
- Housing: High Temperature Thermoplastic (UL94V0)
- Color: natural

## Mechanical and Electrical Performance

- Durability: max 20 mating cycles
- Current Rating: up to 5A
- Operating Temperature: -40°C up to +125°C

## Features

## Benefits

Hermaphroditic “mates to itself” design and Mates under any angle +90° and -60°

Flexible Design for all needs

Reliable dual beam contact

Connection reliability

Self-guided features

Prevent mis-mating and assure correct counterpart positioning

Hold own option

Better retention on to the PCB

Locating pegs

Easy positioning even in manual assembly condition

Passive latch

Better for housing retention

RoHS compliance

Meet environmental, health and safety requirements

# Rotaconnect® - Part numbers

Description	No of contacts	Termination	Contact type	Part number
2 Position Hermaphroditic Rotatable Board-To-Board Connector	2	SMT	1 Male, 1 Female	10120045-200LF
2 Position Hermaphroditic Rotatable Board-To-Board Connector with Locating Pegs	2	SMT	1 Male, 1 Female	10120045-201LF
4 Position Hermaphroditic Rotatable Board-To-Board Connector	4	SMT	2 Male, 2 Female	10120045-400LF
4 Position Hermaphroditic Rotatable Board-To-Board Connector with Locating Pegs	4	SMT	2 Male, 2 Female	10120045-401LF
6 Position Hermaphroditic Rotatable Board-To-Board Connector	6	SMT	3 Male, 3 Female	10120045-600LF

# Rotaconnect<sup>®</sup> - Markets and Applications

- Lighting (Luminaires, signages, displays, etc)
- Control Boards
- Sensors
- Rigid LED Strips
- Automotive Electronics



- Samples available (check with sample room Tatabanya : [samples.global@amphenol-eu.com](mailto:samples.global@amphenol-eu.com))
- Website quick link: <https://www.amphenol-cs.com/product-series/rotaconnect-rotatable-board-to-board.html>
- Available on website
  - Drawings
  - 3D Models
  - Datasheet
  - Product specifications
  - Product presentation

If you have any enquires, please contact to us:

PM Contact: [Pranith.Joy@amphenol-fci.com](mailto:Pranith.Joy@amphenol-fci.com)

PLM Contact: [g.werner@amphenol-eu.com](mailto:g.werner@amphenol-eu.com)

# Thank You

**Amphenol**  
COMMUNICATIONS SOLUTIONS

 **FCi Basics**