

This document is the property of Amphenol Corporation and is delivered on the express condition that it is not to be disclosed, reproduced or used, in whole or in part, for manufacture or sale by anyone other than Amphenol Corporation without its prior consent, & that no right is granted to disclose or to use any information in this document.

CUSTOMER DRAWING

REVISIONS

SYM	ECN	DESCRIPTION	DATE	APPROVED
1	CDXXXX	PRELIMINARY PROPOSAL	Jan.19,2020	YH
2	CDXXXX	ADD PACKING	Mar.17,2020	YH
3	CDXXXX	UPDATE SCHEMATIC BASED ON SFF-TA1009	Apr.8,2020	YH
3	CD2132	OFFICIAL RELEASE	Apr.8,2020	YH
4	CD2662	ADD NEW P/N OPTION	Nov.26,2020	YH
5	CD---	ADD NOTE 6 & 7	Oct.28,2021	YH

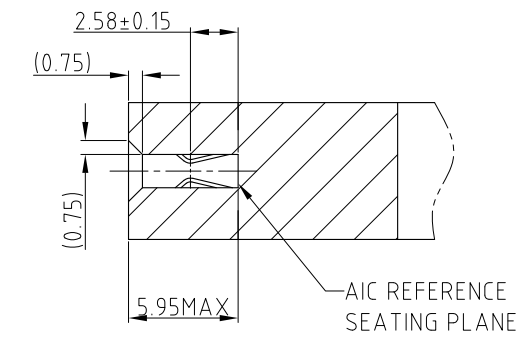
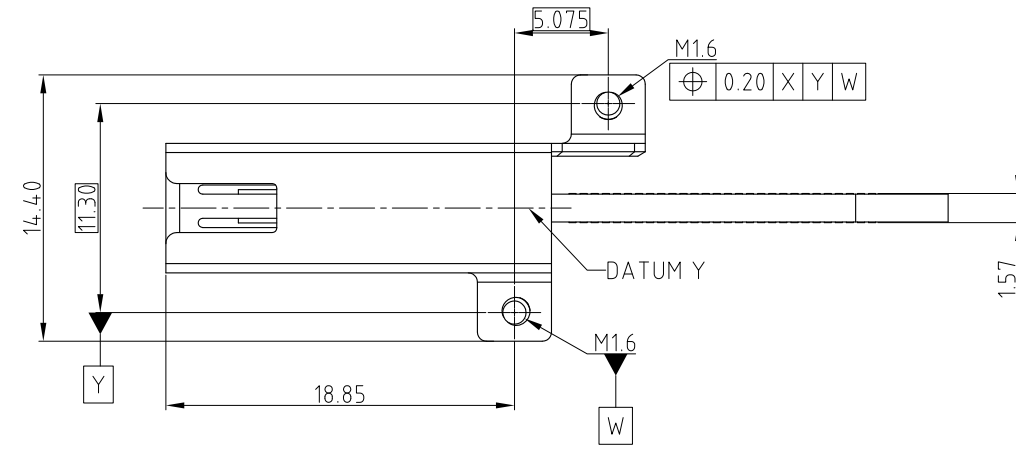

SECTION B-B

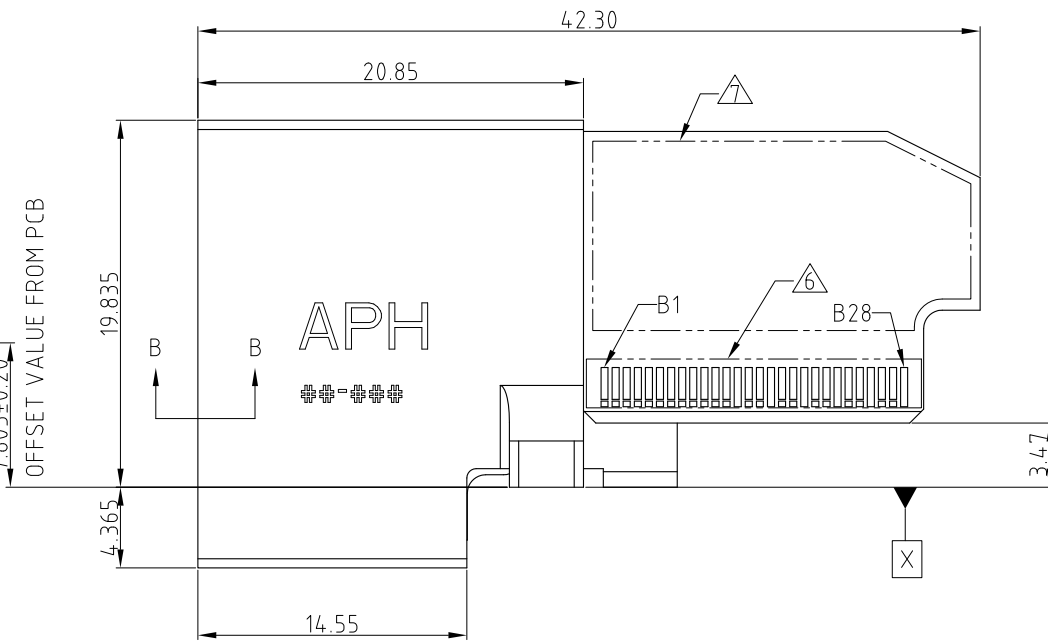
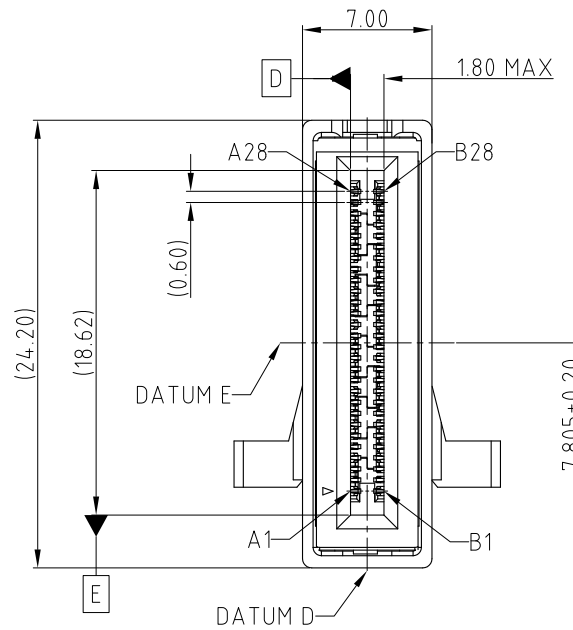

NOTE:

- MATERIAL:
HOUSING: HIGH TEMPERATURE THERMOPLASTIC, BLACK, UL94-V0
CONTACT: COPPER ALLOY
METAL FRAMEWORK: STAINLESS STEEL
- FINISHED:
CONTACT: MATING AREA: 0.76um MIN Au PLATED
OVER 1.27-2.54 um NICKEL UNDERPLATED
SOLDER AREA: 1.27 um MIN TIN OVER 1.27-2.54 um NICKEL UNDERPLATED
- DURABILITY: 200 CYCLES.
- MATERIAL IS FULFILLED RoHS & HALOGEN FREE.
- CONNECTOR IS PACKED IN TRAY
SCREW IS PACKED IN PLASTIC BAG AND BE PLACED IN TOP EMPTY TRAY.
- THE APPEARANCE OF GOLD FINGER IS OPTIONAL FOR REFERENCE
THE DESIGN SUPPORTS REF TA-1012
- PCB MARK INDICATES MANUFACTURING INFORMATION
DRAWING PRINT IS OPTIONAL FOR REFERENCE.
- ORDERING P/N: MEX005630X02111

- 1: GEN3
- 2: GEN4
- 3: GEN5
- 5: WITHOUT M1.6 SCREW SUBASSEMBLY
- 7: WITH M1.6 SCREW SUBASSEMBLY

M1.6 SCREW SUBASSEMBLY (OPTIONAL)

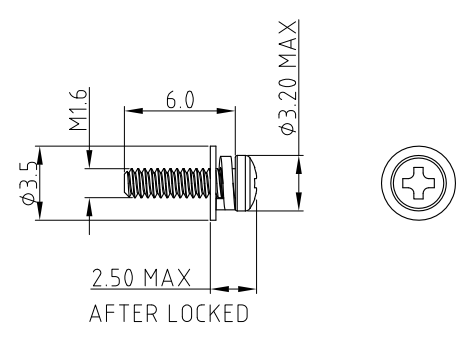

UNLESS OTHERWISE SPECIFIED TOLERANCES	
U.S.	METRIC
.X +/-	0.50
.XX +/-	0.25
.XXX +/-	0.15
FRACTIONS +/-	
ANGLES +/-	5°

APPROVAL		DATE	
DRAWN	Yunx.liu	Oct.28,2021	
CHECKED	Ly.yi	Oct.28,2021	
APPROVED			
DRAWING FILE :		INTERNAL\DRAWING\ME\CMEX005630X02111	
REMOVE SHARP EDGES			
DIMENSIONS			
U.S.	INCHES	ANGLE OF PROJECTION	
(METRIC)	(MM)		

<h1>Amphenol</h1>			
TITLE MINI COOL EDGE ORTHOGONAL 2PCS EDSFF 1x1, 7.805mm OFFSET, 56PIN			
SIZE	DRAWING NO.	REV.	
A3	C MEX005630X02111	5	
SCALE	NONE	SHEET 1 OF 4	

This document is the property of Amphenol Corporation and is delivered on the express condition that it is not to be disclosed, reproduced or used, in whole or in part, for manufacture or sale by anyone other than Amphenol Corporation without its prior consent, & that no right is granted to disclose or to use any information in this document.

CUSTOMER DRAWING

REVISIONS				
SYM	ECN	DESCRIPTION	DATE	APPROVED
		SEE SHEET 1		

ASSEMBLY PROCESS:

1. TO INSERT MINI COOL EDGE ORTHOGONAL 2PCS EDSFF INTO VERTICAL CONNECTOR

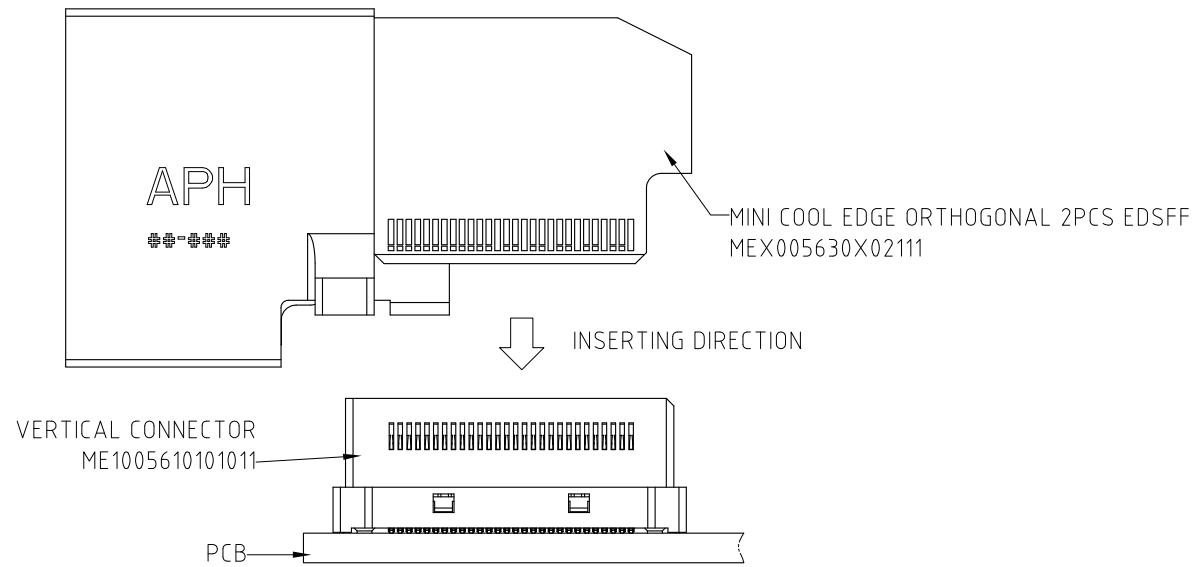

2. TO FIX WITH SCREWS

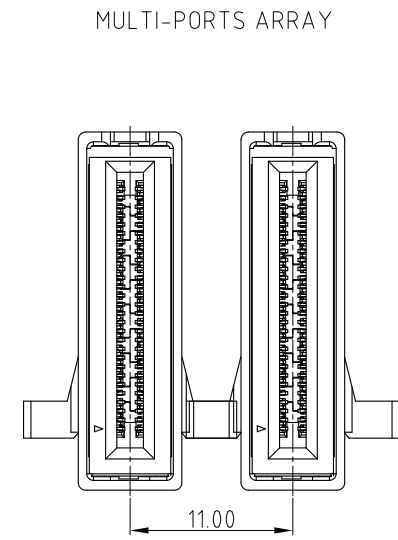
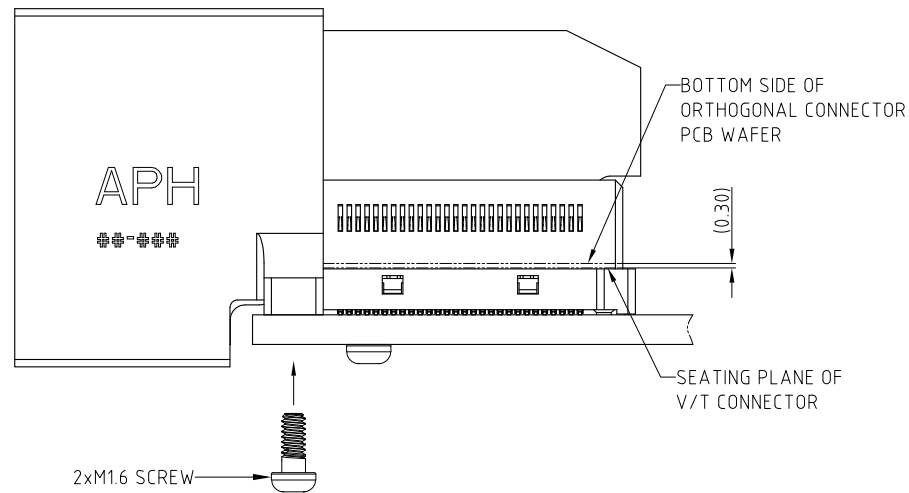

INTERFACE SIDE		FOOTPRINT SIDE	
A1		A1	
A2		A2	
A3		A3	
A4	GND	A4	GND
A5		A5	
A6		A6	
A7	SMBCLK	A7	
A8	SMBDAT	A8	
A9	SMRST#	A9	
A10	LED/ACTIVITY	A10	
A11	PERST1#/CLKREQ#	A11	
A12	PRSNT0#	A12	
A13	GND	A13	GND
A14	REFCLKn1	A14	
A15	REFCLKp1	A15	
A16	GND	A16	GND
A17	PERn0	A17	
A18	PERp0	A18	
A19	GND	A19	GND
A20	PERn1	A20	
A21	PERp1	A21	
A22	GND	A22	GND
A23	PERn2	A23	
A24	PERp2	A24	
A25	GND	A25	GND
A26	PERn3	A26	
A27	PERp3	A27	
A28	GND	A28	GND
B1		B1	
B2		B2	
B3	12v	B3	
B4		B4	
B5		B5	
B6	MFG	B6	
B7	RFU	B7	
B8	DUALPORTEN#	B8	
B9	PERST0#	B9	
B10	3.3Vaux	B10	
B11	PWRDIS	B11	
B12	GND	B12	GND
B13	REFCLKn0	B13	
B14	REFCLKp0	B14	
B15	GND	B15	GND
B16	PETn0	B16	
B17	PETp0	B17	
B18	GND	B18	GND
B19	PETn1	B19	
B20	PETp1	B20	
B21	GND	B21	GND
B22	PETn2	B22	
B23	PETp2	B23	
B24	GND	B24	GND
B25	PETn3	B25	
B26	PETp3	B26	
B27	GND	B27	GND
B28		B28	

SCHEMATIC

UNLESS OTHERWISE SPECIFIED TOLERANCES U.S. METRIC .X +/- .XX +/- .XXX +/- FRACTIONS +/- ANGLES +/- SEE NOTES	APPROVAL		DATE
	DRAWN	Yunx.liu	Oct.28,2021
	CHECKED	Ly.yi	Oct.28,2021
	APPROVED		
FOR MATERIALS AND FINISHES SEE NOTES	DRAWING FILE : INTERNAL\DRAWING\ME\CMEX005630X02111		
REMOVE SHARP EDGES	ANGLE OF PROJECTION		
DIMENSIONS			
U.S.	INCHES		
(METRIC)	(MM)		



<h1>Amphenol</h1>		
TITLE		
MINI COOL EDGE ORTHOGONAL 2PCS EDSFF 1x1, 7.805mm OFFSET, 56PIN		
SIZE	DRAWING NO.	REV.
A3	C MEX005630X02111	5
SCALE	NONE	SHEET 2 OF 4

This document is the property of Amphenol Corporation and is delivered on the express condition that it is not to be disclosed, reproduced or used, in whole or in part, for manufacture or sale by anyone other than Amphenol Corporation without its prior consent, & that no right is granted to disclose or to use any information in this document.

CUSTOMER DRAWING

REVISIONS				
SYM	ECN	DESCRIPTION	DATE	APPROVED
		SEE SHEET 1		

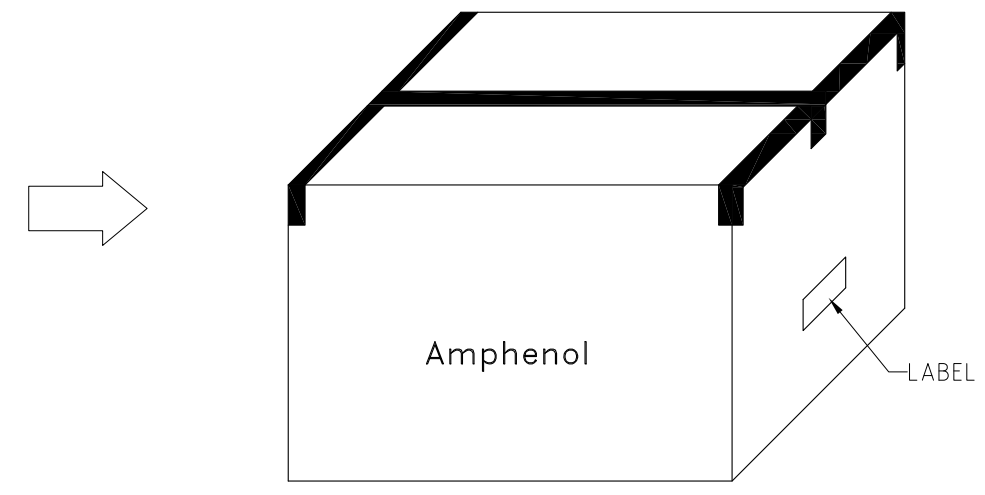
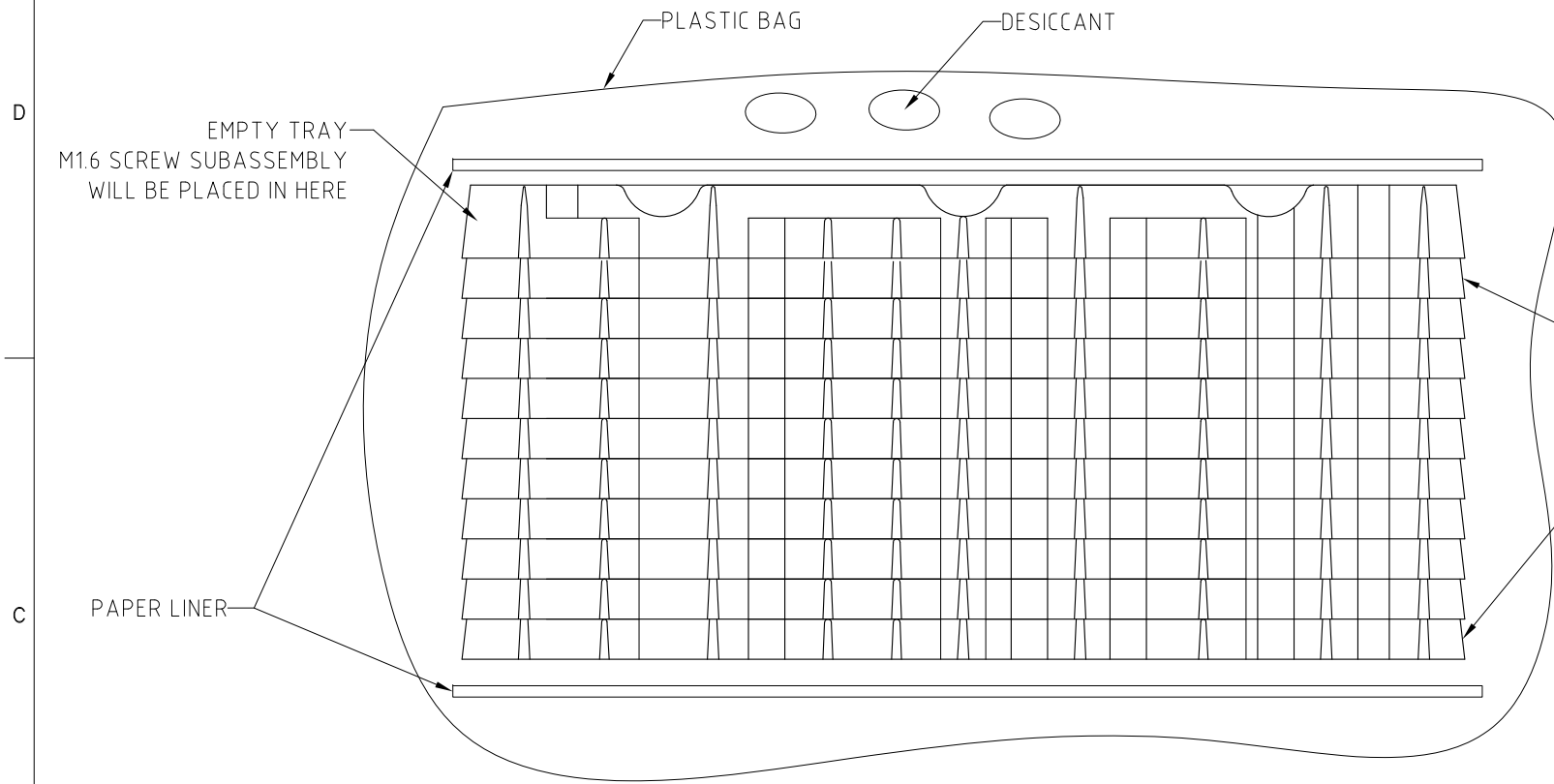

270PCS /CARTON

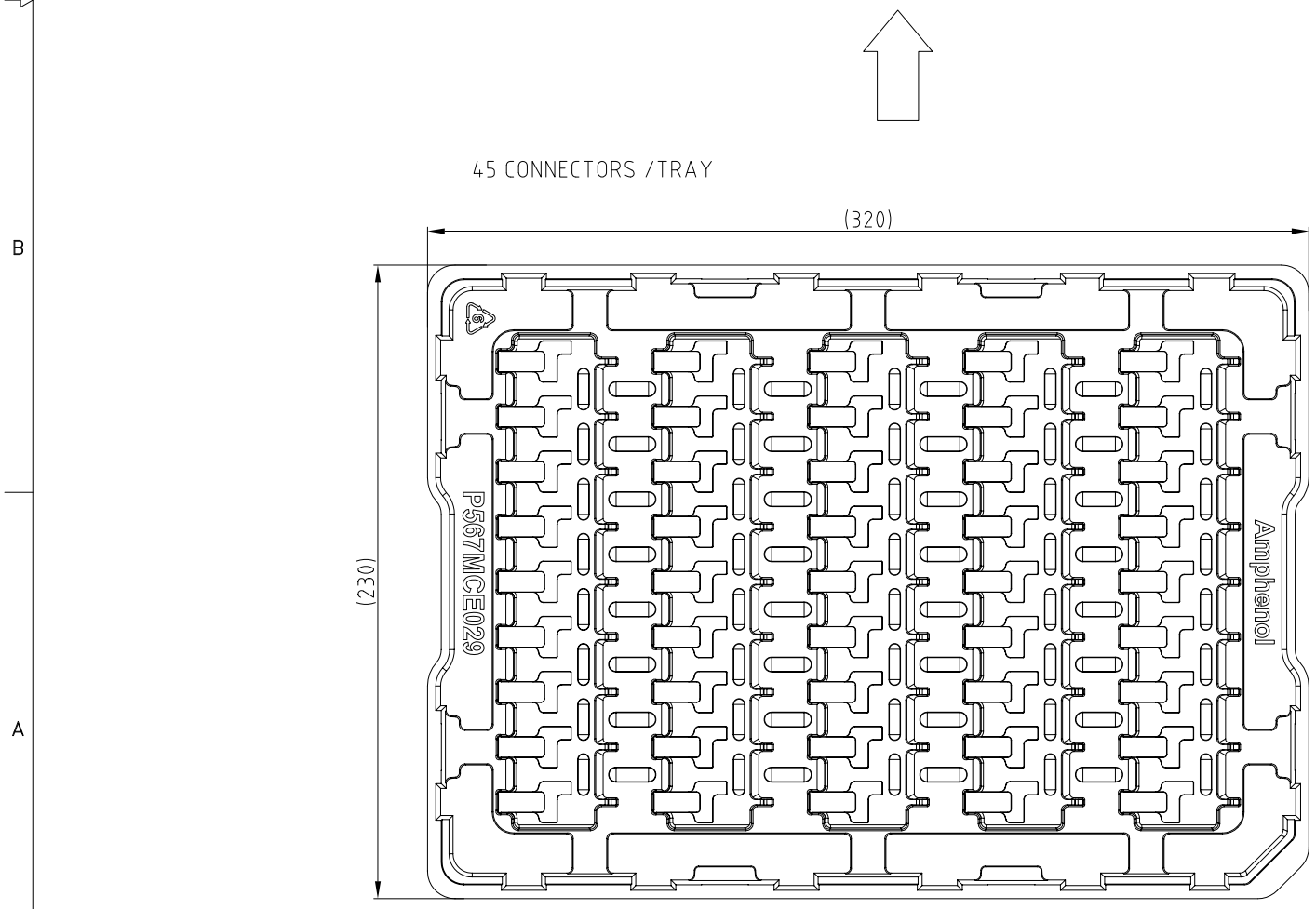

UNLESS OTHERWISE SPECIFIED TOLERANCES U.S. METRIC .X +/- .XX +/- .XXX +/- FRACTIONS +/- ANGLES +/- FOR MATERIALS AND FINISHES SEE NOTES REMOVE SHARP EDGES DIMENSIONS U.S. INCHES (METRIC) (MM)	APPROVAL		DATE
	DRAWN	Yunx.liu	Oct.28,2021
	CHECKED	Ly.yi	Oct.28,2021
	APPROVED		
DRAWING FILE :		INTERNAL\DRAWING\ME\CMEX005630X02111	
ANGLE OF PROJECTION			

Amphenol		
TITLE		
MINI COOL EDGE ORTHOGONAL 2PCS EDSFF 1x1, 7.805mm OFFSET, 56PIN		
SIZE	DRAWING NO.	REV.
A3	C MEX005630X02111	5
SCALE	NONE	SHEET 4 OF 4