

This document is the property of Amphenol Corporation and is delivered on the express condition that is not to be disclosed, reproduced or used, in whole or in part, for manufacture or sale by anyone other than Amphenol Corporation without its prior consent, and that no right is granted to disclose or to use any information in this document.

The marking on this product doesn't contain environmental hazardous materials per Material Specification SS-00259 for Sony GP compliant or per directive 2011/65/EU for RoHS compliant or per IEC 61249-2-21 for Halogen-Free compliant.

REVISIONS				
SYM	ECN No.	DESCRIPTION	DATE	BY
AX1		INITIAL REVISION	2018.07.26	Sondra Sang

DATE CODE
 Y WW D
 1~7: DATE NO.
 12: WEEK NO.
 6: 2016

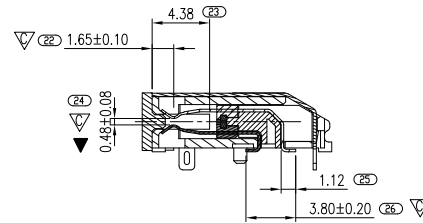
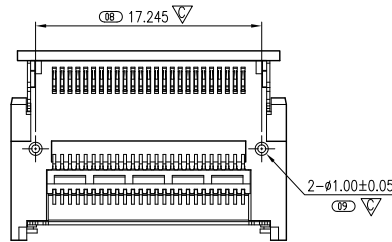
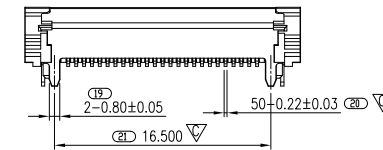
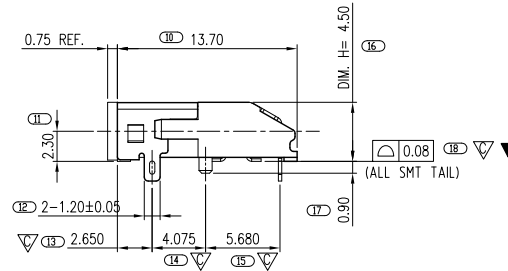
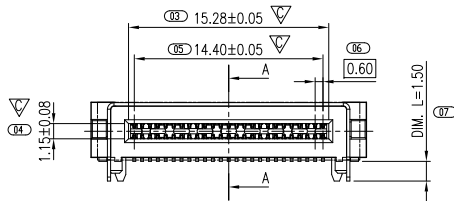
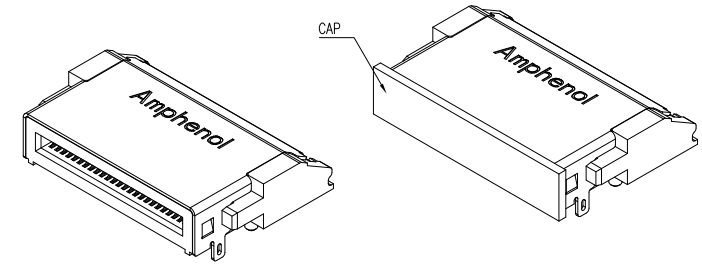
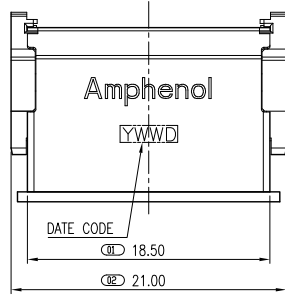

PART NUMBER:
 G13A 50 1 X 1 2 X 3 X HR

CONN. STYLE
 1: R/A, H4.5mm

CONTACT FINISH
 0: GOLD FLASH
 1: 15µ" GOLD
 2: 30µ" GOLD

TERMINAL STYLE
 1: SMT TYPE

PACKING METHOD
 2: TAPE & REEL (STANDARD)

LOCK OPTIONS
 3: LOCK RING

INSULATOR OPTION
 1: LCP, BLACK

SHELL OPTION
 2: SHELL DIP, L=1.5mm

- NOTES:
- HOUSING: LCP (E130i), UL 94V-0, COLOR- BLACK
 - CONTACT: BRONZE (C7035-TM06), 0.20mm THICKNESS, SELECTIVE GOLD PLATED ON CONTACT AREA, 100µ" MATTE TIN PLATED ON SOLDERING TAIL, 50µ" MIN. NICKEL UNDER-PLATED OVERALL
 - SHELL: STAINLESS STEEL (SUS304), 0.25mm THICKNESS, 60µ"~150 µ" MIN. MATTE TIN PLATED ON SOLDERING TAILS OVER 50µ" MIN. NICKEL PLATED OVERALL
 - INSERT-MOLD/ REAR GUIDE: LCP (E130i), UL 94V-0, COLOR- BLACK
 - PACKAGE DRAWING REFER TO PKS-G13AP001HR; PRODUCT SPECIFICATION: PS-
 - Ø MUST BE MEASURED BY FAI.
 - MAJOR DIMENSION ▽ SHOULD BE CONTROLLED BY QIP.
 - ▼ MUST BE CONTROLLED BY SPC.
 - THIS PRODUCT DOESN'T CONTAIN ENVIRONMENTAL HAZARDOUS MATERIALS PER DIRECTIVE 2011/65/EC FOR RoHS AND PER IEC 61249-2-21 FOR HALOGEN FREE COMPLIANT.

TOLERANCE	DRAWN	APPROVALS	DATE	TITLE	UNIT	SCALE	SIZE	PART No.
X. ±0.20 X.X ±0.15 X.XX ±0.10 X.XXX ±0.05	DESIGNED	Sondra Sang	07/26/2018	EXTREMEPORT FLASH 8X CONN. RECEPTACLE, R/A HEIGHT 4.5mm	m	NA	A3	G13A 501X 12X 3X HR
	CHECKED	Chenny Yeh	07/26/2018					
ANGULAR ±1°	APPROVED	Hank Hsu	07/26/2018					
UNLESS OTHERWISE SPECIFIED	DWG TYPE	ENG DWG	PROJECT CODE TXXX					E-G13A501X12X3XHR
								REV. AX1

Amphenol®
 Amphenol Corporation
 Amphenol Taiwan Corporation