

| REVISIONS | | | |
|-----------|---------------------------------|----------|-------|
| REV | DESCRIPTION, ECN, EAR NO. | DATE | APP'D |
| D | LATCH UPDATED | MAR12/21 | S.M. |
| E | PRODUCT DWG - REV PER EAR 15180 | MAY17/23 | M.P. |

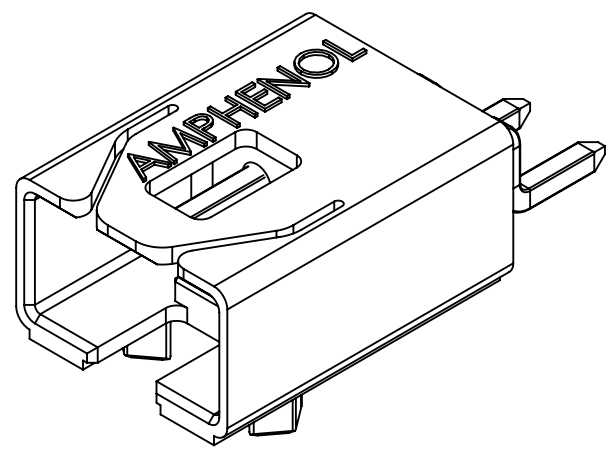
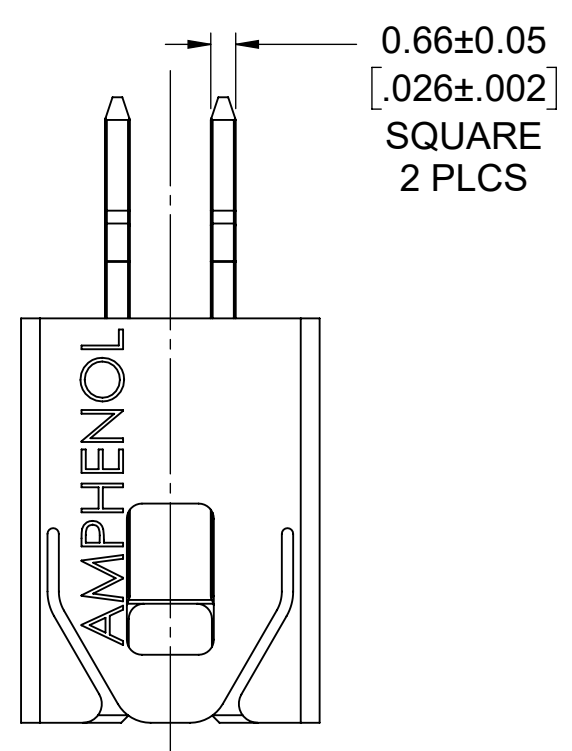

ORDERING CODE: FLM - P 2 2 - XX

FLM SERIES

RECEPTACLE CONNECTOR (PIN CONTACTS)

2 - POSITIONS

R/A BOARD MOUNT, SMT TAILS

HOUSING COLOUR

00 = BLACK (STANDARD)
W0 = WHITE

FOR CUSTOM REQUESTS, CONSULT AN AMPHENOL REPRESENTATIVE.

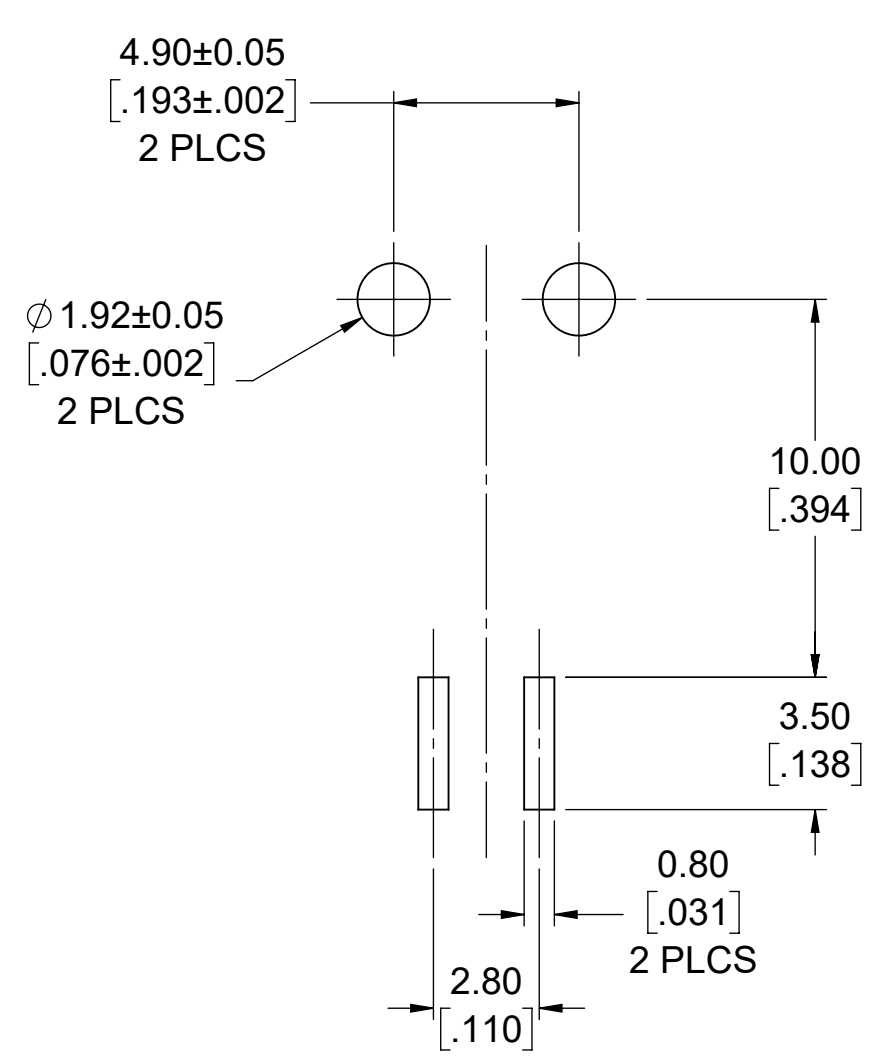
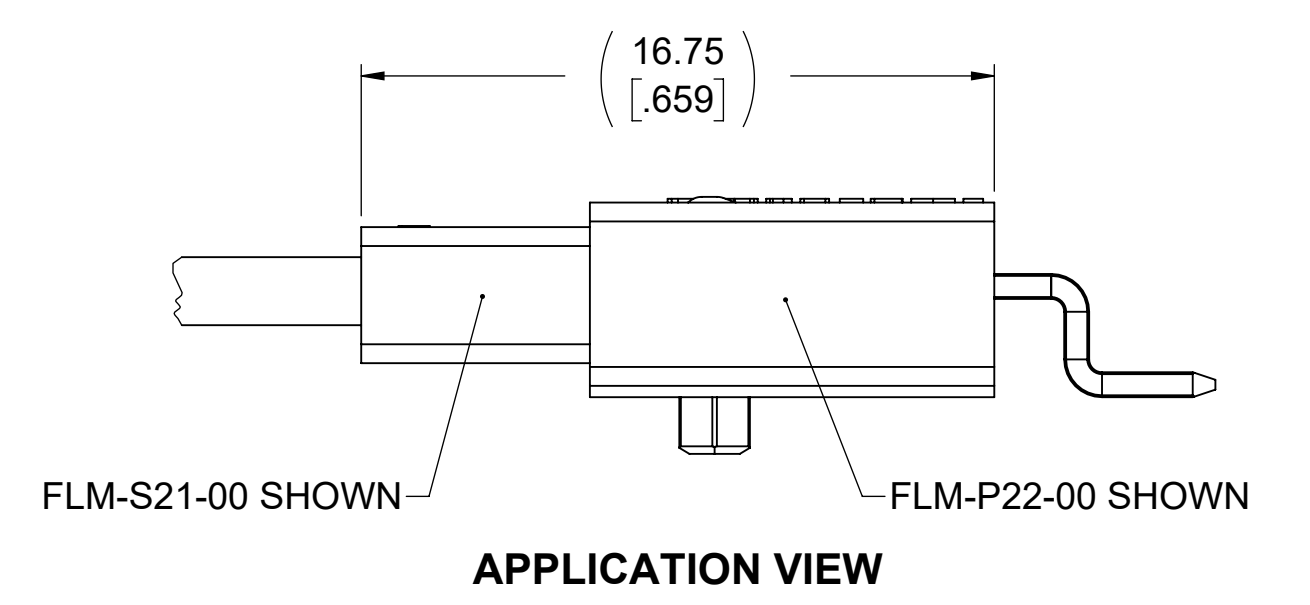
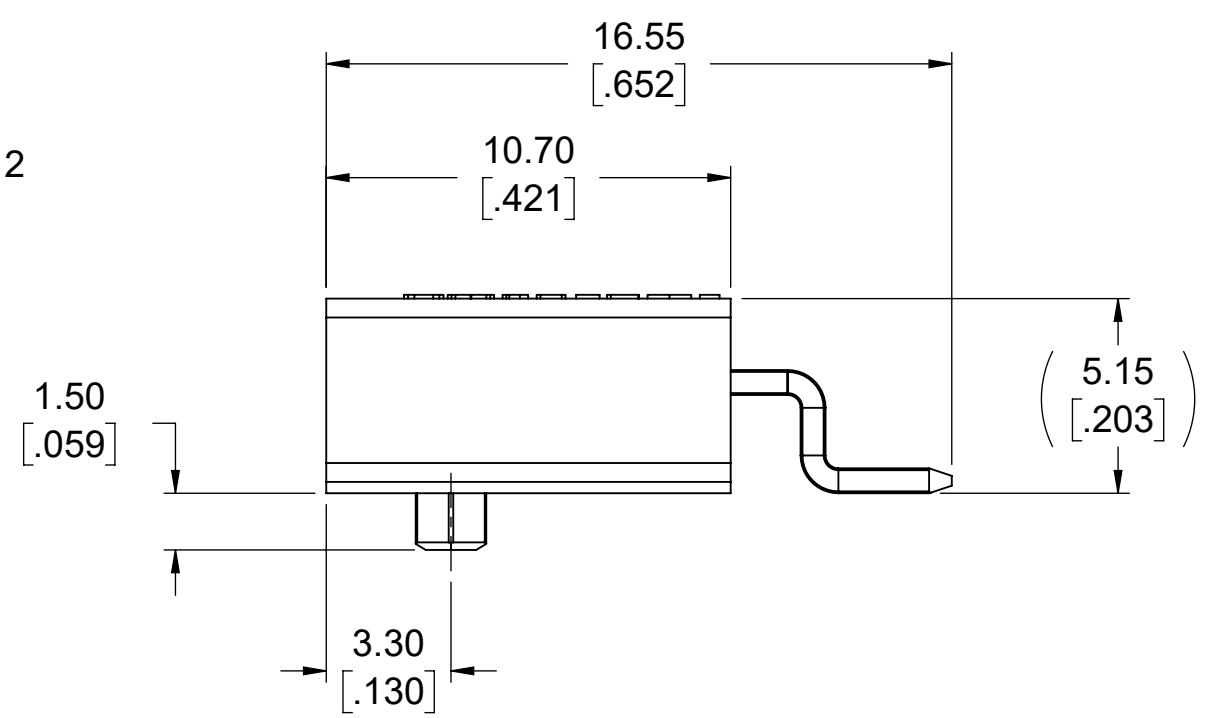
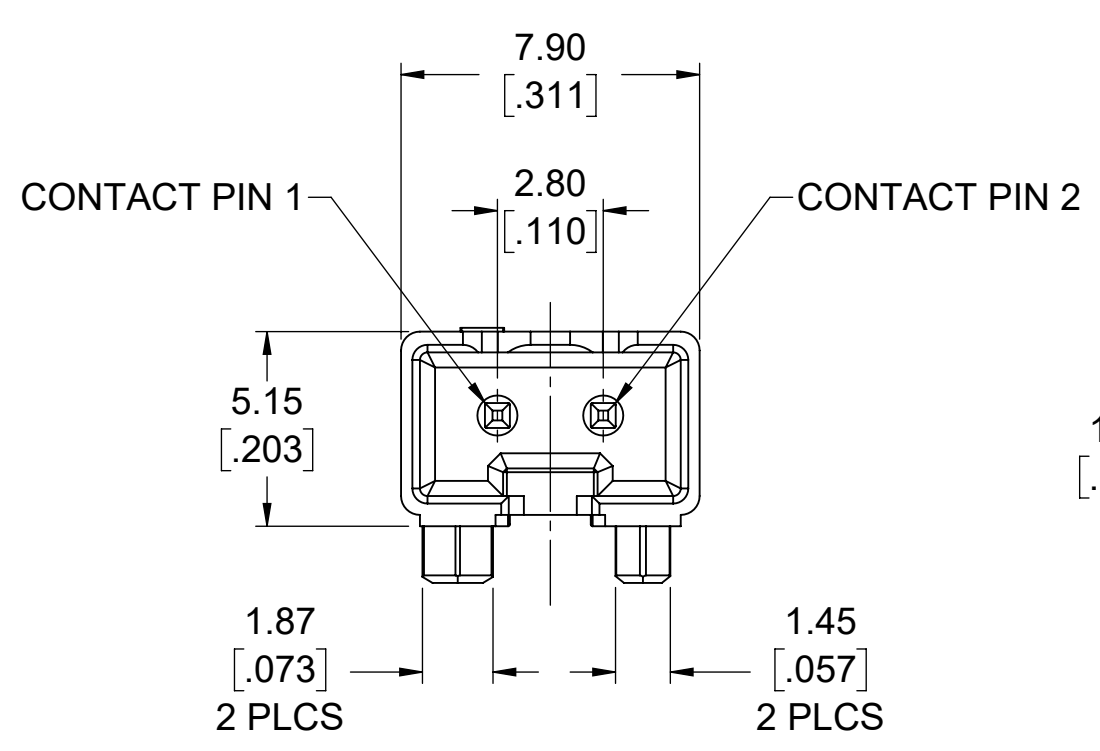

RECOMMENDED PCB LAYOUT
COMPONENT SIDE OF BOARD

| CONTACT NO. | CONTACT ASSIGNMENT |
|-------------|---------------------------------------|
| 1 | DA- (NEGATIVE POLE FOR DALI PROTOCOL) |
| 2 | DA+ (POSITIVE POLE FOR DALI PROTOCOL) |

NOTES:

- MATERIALS:** ALL MATERIALS ARE RoHS COMPLIANT PER EU DIRECTIVE 2011/65/EU & AMENDMENTS
 - HOUSING: ENGINEERING THERMOPLASTIC, UL FLAMMABILITY RATING: UL94V-0, COLOUR AS PER ORDERING CODE
 - CONTACT PINS: COPPER ALLOY, MATTE TIN OVER NICKEL PLATING
- ELECTRICAL CHARACTERISTICS:**
 - CURRENT RATING: 7 A (18 AWG) OR 5 A (20 AWG) OR 3 A (22 AWG) PER CONTACT
 - VOLTAGE RATING: 30 VDC
 - DIELECTRIC WITHSTANDING VOLTAGE: 1500 VAC
 - INSULATION RESISTANCE: 500 MEGAOHMS
- OPERATING TEMPERATURE:** -40°C TO +105°C
- CONFORMS TO ZHAGA BOOK 20, LEX MODULE RECEPTACLE (LEX-MR).**



| | | | |
|----------------------------|------------------------|----------|----------|
| UNLESS SPECIFIED OTHERWISE | DRAWN | S. MUGAN | MAR27/20 |
| PRIMARY UNITS MILLIMETRES | CHECKED | A. GREEN | MAR27/20 |
| SECONDARY INCHES | M.E. APP'D | | |
| REFERENCE IN PARENTHESES | Q.A. APP'D | | |
| GENERAL TOLERANCES | DWG APPR. | | |
| 1 DECIMAL PLACE | ENG. REL. NO. | | |
| 2 DECIMAL PLACES ±0.10 | REF. | | |
| 3 DECIMAL PLACES | | | |
| ANGULAR DEGREES | THIRD ANGLE PROJECTION | | |

Amphenol Canada Corp.
Commercial Products

FLM SERIES, ZHAGA BOOK 20, LEX MODULE RECEPTACLE (LEX-MR), R/A BOARD MOUNT, SMT TAILS, RoHS COMPLIANT

DWG. NO. **P-FLM-P22-XX** REV **E**

CODE ID NO. 03554 DWG SIZE: X SCALE: 5:1 SHEET 1 OF 1